

Blue Earth Airport Funding

2010 Budget Discussions

Attachment "B"



Revenue Budget Worksheet/nt

MARCH 2010

FUND Descr	CAT Account Descr	Prior Yr Amt	2009 Budget	2009 Amt	2009 YTD Amt	2010 Budget	2010 YTD Amt
FUND 210 AIRPORT FUND							
CATEGORY 05 TAXES AND FRANCHISES							
AIRPORT FUND	05 R 210-05-31010 PROPERTY TAXES	\$0.00	\$27,931.00	\$23,701.29	\$0.00	\$16,409.00	\$0.00
CATEGORY 15 GOVERNMENTAL REVENUES							
AIRPORT FUND	15 R 210-15-33402 MVHC TAX CREDITS	\$0.00	\$0.00	\$3,799.49	\$0.00	\$0.00	\$0.00
	15 R 210-15-33417 LOCAL GOVERNMENT	\$0.00	\$47,570.00	\$47,570.00	\$0.00	\$61,443.00	\$0.00
	15 R 210-15-33423 GOVERNMENTAL AG	\$170,613.81	\$77,431.00	\$371,074.66	\$44,036.00	\$0.00	\$0.00
	15 R 210-15-33424 STATE REIMBURSMN	\$17,214.00	\$17,214.00	\$17,214.00	\$0.00	\$0.00	\$0.00
CATEGORY 15 GOVERNMENTAL REVENUES		\$187,827.81	\$142,215.00	\$439,658.15	\$44,036.00	\$61,443.00	\$0.00
CATEGORY 45 OTHER REVENUES							
AIRPORT FUND	45 R 210-45-34113 POP/STACK/MISC RE	\$46.00	\$0.00	\$32.52	\$3.67	\$0.00	\$7.39
	45 R 210-45-34950 REFUNDS-REIMBUR	\$267.84	\$0.00	\$268.95	\$0.00	\$0.00	\$0.00
	45 R 210-45-36200 DONATIONS	\$0.00	\$0.00	\$0.00	\$0.00	\$0.00	\$0.00
	45 R 210-45-36202 SALE OF PROPERTY	\$0.00	\$0.00	\$0.00	\$0.00	\$0.00	\$0.00
	45 R 210-45-36210 INTEREST EARNING	\$130.47	\$3,000.00	-\$608.42	\$0.00	\$0.00	\$0.00
	45 R 210-45-36400 RENT-ROYALTIES	\$32,620.98	\$29,000.00	\$32,620.98	\$0.00	\$33,000.00	\$0.00
	45 R 210-45-36401 HANGER RENT	\$24,376.40	\$21,000.00	\$22,082.36	\$7,346.00	\$24,000.00	\$0.00
	45 R 210-45-36403 PUMP FLOWAGE FE	\$1,692.68	\$1,000.00	\$934.74	\$0.00	\$1,000.00	\$7,803.10
	45 R 210-45-36404 FBO HANGAR RENT	\$5,275.00	\$6,000.00	\$2,250.00	\$0.00	\$4,000.00	\$0.00
CATEGORY 45 OTHER REVENUES		\$64,409.37	\$60,000.00	\$57,581.13	\$7,349.67	\$62,000.00	\$7,810.49
CATEGORY 50 TRANSFERS OTHER REVENUE							
AIRPORT FUND	50 R 210-50-39201 TRANSFER IN	\$0.00	\$0.00	\$0.00	\$0.00	\$0.00	\$0.00
FUND 210 AIRPORT FUND		\$252,237.18	\$230,146.00	\$520,940.57	\$51,385.67	\$139,852.00	\$7,810.49

Expenditure Budget Worksheet nt

Current Period: MARCH 2010

Account Descr	Prior Yr Amt	Last Yr Budget	2009 Amt	2009 YTD Amt	2010 Budget	YTD Amount:
FUND 210 AIRPORT FUND						
DEPT 49810 AIRPORT						
OBJECT Alt Code 100PERS						
E 210-49810-109 WORKERS' COMP	\$76.47	\$0.00	\$39.04	\$39.04	\$48.41	\$48.94
OBJECT Alt Code 200SUPP						
E 210-49810-201 SUPPLIES	\$783.43	\$2,000.00	\$769.27	\$255.06	\$1,500.00	\$52.161
E 210-49810-203 POSTAGE/PUBLISHING/	\$561.84	\$500.00	\$3,042.60	\$91.81	\$300.00	\$35.121
E 210-49810-204 MOTOR FUEL	\$2,834.27	\$2,000.00	\$2,088.98	\$244.54	\$1,500.00	\$637.401
OBJECT Alt Code 300SERVC						
E 210-49810-301 COMMUNICATIONS	\$369.68	\$370.00	\$372.38	\$61.36	\$370.00	\$62.681
E 210-49810-304 MAINTENANCE & REPAI	\$11,554.55	\$4,000.00	\$7,167.35	\$212.45	\$4,000.00	\$91.431
E 210-49810-305 TRAVEL/MEETINGS ETC.	\$130.68	\$500.00	\$100.00	\$100.00	\$250.00	\$50.001
E 210-49810-310 BUILDING REPAIRS	\$0.00	\$500.00	\$0.00	\$0.00	\$500.00	\$0.001
E 210-49810-312 HIRED SERVICES	\$132,310.57	\$50,000.00	\$14,416.40	\$83,095.50	\$50,000.00	\$1,234.001
E 210-49810-315 MISCELLANEOUS	\$1,811.15	\$1,000.00	\$1,775.09	\$265.80	\$1,000.00	\$182.351
E 210-49810-316 MAINTENANCE AGREEM	\$0.00	\$0.00	\$0.00	\$0.00	\$0.00	\$0.001
E 210-49810-318 INSURANCE/BONDS	\$34,974.00	\$34,975.00	\$36,736.00	\$0.00	\$36,736.00	\$0.001
E 210-49810-319 UTILITIES	\$10,608.33	\$14,000.00	\$10,140.05	\$3,076.20	\$12,000.00	\$2,724.451
E 210-49810-325 PROPERTY TAXES/SPEC	\$4,316.00	\$4,300.00	\$5,084.00	\$0.00	\$5,090.00	\$0.001
E 210-49810-354 CRACK FILLING	\$0.00	\$0.00	\$0.00	\$0.00	\$0.00	\$0.001
E 210-49810-359 USE TAX	\$0.00	\$0.00	\$0.00	\$0.00	\$0.00	\$0.001
OBJECT Alt Code 300SERVC	\$196,074.96	\$109,645.00	\$75,791.27	\$86,811.31	\$109,946.00	\$4,344.911
OBJECT Alt Code 400/PROJ						
E 210-49810-409 AIRPORT CONSTRUCTIO	\$0.00	\$0.00	\$4,900.00	\$0.00	\$26,556.00	\$38,500.001
E 210-49810-410 AIRPORT IMPROV ENGI	\$0.00	\$0.00	\$343,126.69	\$0.00	\$0.00	\$8,667.531
OBJECT Alt Code 400/PROJ	\$0.00	\$0.00	\$348,026.69	\$0.00	\$26,556.00	\$47,167.531
OBJECT Alt Code 500CAPOU						
E 210-49810-501 CAPITAL-EXPENSE	\$124,965.50	\$40,500.00	\$7,540.00	\$0.00	\$0.00	\$0.001
DEPT 49810 AIRPORT	\$325,296.47	\$154,645.00	\$437,297.85	\$87,441.76	\$139,852.41	\$52,286.061

9

CIP Plan

Date: 09/28/09

FINAL FEDERAL FY 2010/STATE FY 2011 CIP																			
State FY	Fed FY	Description	FAA %	Funding % State %	Funding % Local %	Project Cost	FAA Entitlement Funding	Federal Discretionary Funding	State Funding	Local Funding	Other Programs	Local Project Priority	Project Bid Date	Federal Entitlement Balance					
2010		Runway 16 Approach Land Acquisition - PHASE I	95%	0%	5%	200,000	190,000	0	0	10,000	0	2		\$202,000					
2010		Parallel Taxiway Apron Extension & Reconstruction	95%	0%	5%	3,296,926	202,000	2,830,000	0	154,846	0	3	4/15/2010	Entitlements / Discretionary \$150,000					
2011		Runway 16 Approach Land Acquisition - PHASE I	85%	0%	5%	300,000	150,000	135,000	3	15,000	0	2		FY 2011 Entitlement Balance \$150,000					
2011		Runway 16-34 Reconstruction & Extension (1200'), Lighting, Parallel Taxiway 1, 200' Extension, Terminal Area Reconstruction	95%	0%	5%	3,300,000	0	3,135,000	3	165,000	0	3	4/15/2010	Entitlements / Discretionary Federal \$150,000					
2011		FBO Hangar Pedestrian Walkway	0%	50%	50%	40,000	0	0	20,000	20,000	0	1		Discretionary \$0					
2012		Arrival/Departure Building Expansion	0%	70%	30%	105,000	0	0	76,500	81,500	0	1	4/15/2012	FY 2012 Entitlement Balance \$150,000					
2012		Strip Nish Facility Roof	0%	70%	3000%	85,000	0	0	59,500	2,950,000	0	2	9/15/2012						
2013		Concrete Apron Expansion, Hangar Site Teallane (South End) - Phase I	95%	0%	5%	515,000	489,250	0	0	25,750	0	1	4/15/2013						
2015		Taxilane Widening, T-Hangar Site Preparation - North End	95%	0%	5%	310,000	294,900	0	3	15,100	0	1	4/15/2015						
2015		10 Unit T-Hangar Building	0%	50%	50%	515,000	0	0	257,800	257,200	0	2	4/15/2015						
2015		Airport Fencing	95%	0%	5%	105,000	98,750	0	0	5,250	0	3	4/15/2015						
2016		Environmental Assessment for 3,900 feet	85%	0%	5%	60,000	85,500	0	0	4,500	0	1							
2018		Runway 16/34 Approach Land Acquisition - Precision Approach (131 AC)	95%	0%	5%	700,000	0	665,000	0	35,000	0	1							
2018		Runway 16/34, Parallel Taxiway Extension (4,600' to 5,300') - DESIGN	95%	0%	5%	200,000	218,500	0	0	11,500	0	2							
2019		3654 sq. Improvements	95%	0%	5%	316,000	294,500	0	0	15,500	0	1	4/15/2019						
2019		Runway 16/34 Extension & Widening, Parallel Taxiway Extension (4,600' x 73' to 5,300' x 107') - CONSTRUCTION	95%	0%	5%	3,100,000	0	2,945,000	0	155,000	0	2	4/15/2019						
2019		Concrete Apron Expansion, Hangar Site Teallane (South End) - Phase II	95%	0%	5%	310,000	294,500	0	0	15,500	0	3	4/15/2019						
Summary for Airport - Blue Earth Municipal Airport																			
Totals														13,611,926	2,318,580	9,610,000	410,500	3,467,246	0

With & Without Projects

Airport Revenue and Expenses Spread Sheet

	2008 Revenue	Expenses	Balance	2009 Revenue	Expenses	Balance	2010 Revenue	Expenses	Balance
Levy	-	-	45,539	27,500	-	268,229	16,409	-	-
Rents	64,409	-	-	57,581	-	-	62,000	-	-
Govt. Agree	187,827	-	-	47,570	-	-	61,443	-	-
	<u>252,236</u>			<u>132,651</u>			<u>139,852</u>		
Operation Engineer.	-	68,021	-	67,275	67,275	-	200,000	200,000	-
CIP	-	124,965	-	-	-	-	3,296,926	3,296,926	-
		<u>124,965</u>		<u>343,126</u>			<u>63,294</u>		
		<u>317,951</u>		<u>410,401</u>			<u>-</u>		
Bond Rev.	-	-	-	-	-	-	-	-	-
FAA 08	-	-	-	371,075	-	-	164,846	-	-
MN-DOT	-	-	-	<u>24,214</u>	-	-	<u>3,120,000</u>	-	-
				<u>395,289</u>			<u>26,214</u>		
2008 audit				2009 yr. end			3,311,060	ending bal.	158,921

	2008 Revenue	Expenses	Balance	2009 Revenue	Expenses	Balance	2010 Revenue	Expenses	Balance
Levy	-	-	59,141	-	-	66,661	-	-	-
Rents	64,409	-	-	57,581	-	-	62,000	-	-
Govt. Aid	17,214	-	-	-	-	-	-	-	-
	<u>81,623</u>						<u>62,000</u>		
Operation Engineer.	-	68,021	-	67,275	67,275	-	63,294	63,294	-
CIP	-	-	-	-	-	-	-	-	-
		<u>68,021</u>		<u>67,275</u>			<u>63,294</u>		
Bond Rev.	-	-	-	-	-	-	-	-	-
FAA 08	-	-	-	-	-	-	-	-	-
MN-DOT	-	-	-	<u>17,214</u>	-	-	<u>17,214</u>	-	-
				<u>17,214</u>			<u>17,214</u>		
2008 audit				2009 yr. end			ending bal.	82,581	

Expenditures

• Supplies	5,900
• Hired services	
– Airport mgt.	7,404
– Snow removal	1,292
– Mowing	3,489
– Misc	2,231
• Maint. & Rep.	7,167
• Insurance	36,736
• Utilities	10,140
• Taxes	5,084
• Misc.	2,248

Revenues

- FAA – Entitlement Funds - \$150,000 per yr.
- Discretionary Funds- project dependent
- Mn-DOT – CIP Funds - project dependent
- Maintenance Funds - for day to day costs
- Rents - Hanger - \$23,340
 - FBO \$5,400
 - Farmland \$25,713
 - Flowage Fees \$935

Renter Breakdown

		Rent
#1 Royer, Dick	green hangar/east side	\$70
#2 Skogen Bros.	green hangar/west side	\$75
#3 Pankratz, Gordon	green hangar/east side	\$70
#4 Bauer, James	green hangar/west side	\$75
#5 Holland, Ray	green hangar/east side	\$70
#6 Coy, Les	green hangar/west side	\$75
#7 Nimz, Roger	yellow hangar/east side	\$70
#8 Golly, Tom	yellow hangar/west side	\$75
#9 Hoppe, Matthew	yellow hangar/east side	\$70
#10 Hoppe, Matthew	yellow hangar/west side	\$75
#11 Baxter, Dennis	yellow hangar/east side	\$70
#12 BE Aviation	yellow hangar/west side	\$75
#13 Paschke, Howard	yellow hangar/east side	\$70
#14 Foster, Gary	yellow hangar/west side	\$75
#15 Zierke, Tony	yellow hangar/east side	\$70
#16 Ekse, Jim	yellow hangar/west side	\$75
#17 Potter, Rick	yellow hangar/east side	\$70
#18 Stoltzman, Keith	yellow hangar/west side	\$75
#19 Vogt, Carl	blue hangar/ east side	\$75
#20 Wessels, Everett	blue hangar/ west side	\$80
#21 Thoreson, Al	blue hangar/ east side	\$75
#22 Circle 5	blue hangar/ west side	\$80
#23 City (tractor)	blue hangar/ east side	\$75
#24 Goossen, John	blue hangar/ west side	\$80
#25 BE Aviation	blue hangar/ east side	\$75
#26 blue Skogen Bros.	blue hangar/ west side	\$80
FBO BE Aviation	Jan. 1 - May 31, 2010	\$450/per month
Murphy, Brent garage		\$55
Wirth, Brett garage		\$40

Airport Mgt. Agreement

- Minor Maintenance
- Janitorial Duties
- Assist pilots in transportation
- Lighting Checks
- Safety Checks
- File Notices to Air Men
- Promotion
- Rental Agent
- NPSDES report
- Mowing
- Snow removal
- Insurance – manager’s liability, hanger keepers, & fueling
- .05 of Flowage Fee

Mowing

•	<u>Airport mowing service</u>	
•	2006	
•	Part 1 service/maintenance lawn	
•	\$1,114.04	
•	81.5 hrs.	
•	Part 2 labor, lease, fuel, oil	
•	\$2,153.86	
•	66.75 hrs.	
•	Chemicals for spraying	
•	\$475.50	
•	Total \$3,743.40	
•	2007	
•	Part 1 service/maintenance lawn	
•	\$901.75	
•	64. hrs.	
•	Part 2 labor, lease, fuel, oil	
•	\$2,366.58	
•	71.5 hrs.	
•	Total \$3,268.33	
•	2008	
•	Part 1service/maintenance lawn	
•	\$857.45	
•	59. hrs.	
•	Part 2 labor, lease, fuel, oil	
•	\$2,172.06	
•	63.75 hrs.	
•	Total 2008	
•	\$3,029.51	
•	2009	
•	Part 1service/maintenance lawn	
•	\$1,360.69	
•	75. hrs.	
•	Part 2 labor, lease, fuel, oil	
•	\$2,128.70	
•	60.75 hrs.	
•	Total \$3,489.39	

Snow Removal

• Airport snow removal service 2006

• Part 1 Snow removal service

• \$407.48

• 30.5 hrs.

• Part 2 Lease of JD w/loader

• \$580.32

• 12 hrs.

• **Total**

• **\$987.80**

• Airport snow removal service 2007

• Part 1 Snow removal service

• \$1,518.20

• 109.5 hrs.

• Part 2 Lease of JD w/loader

• \$2,380.96

• 46. hrs.

• **Total**

• **\$3,899.16**

• Airport snow removal service 2008

• Part 1 Snow removal service

• \$1,270.85

• 88.5 hrs.

• Part 2 Lease of JD w/loader

• \$2,127.87

• 20.5 hrs.

• **Total**

• **\$3,398.72**

• Airport snow removal service 2009

• Part 1 Snow removal service

• 634.67

• 43.5 hrs.

• Part 2 Lease of JD w/loader

• 657.54

• 6. hrs.

• **Total**

• **\$1,292.21**

FBO Lease

- Rent FBO Hanger Space (5,625 ft.) \$5,400
- Renter pd. Utilities
- Renter pd. Insurance; liability and damage,
Workers Comp. & fuel spills

Airport Layout

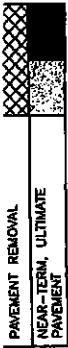
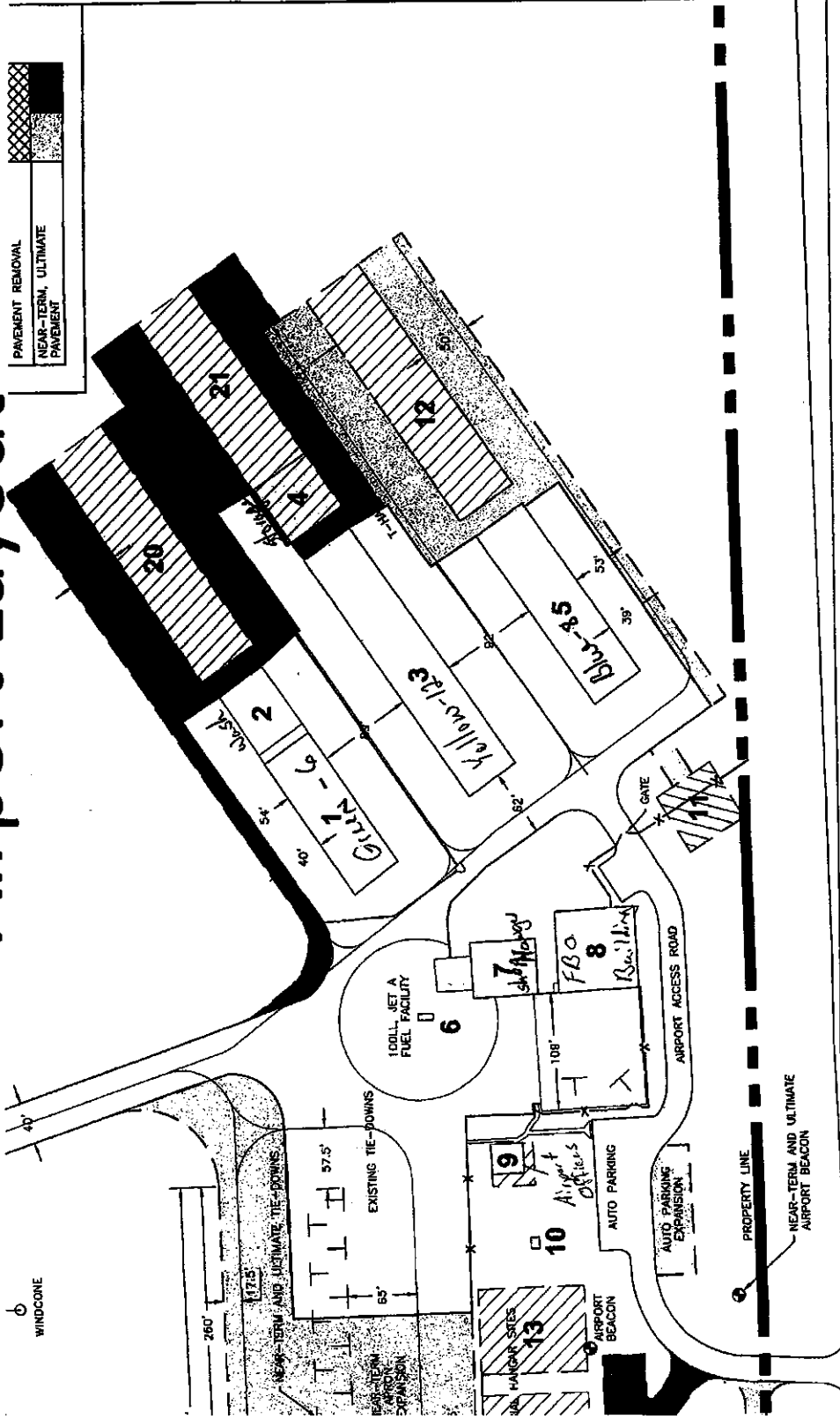

NO.	BUILDING TYPE	OWNER	TOP ELEV.	ULTIMATE DISPOSITION
1	6-UNIT T-HANGAR	CITY OF BLUE EARTH	1125' EST.	TO REMAIN
2	SPRAY-WASH FACILITY	CITY OF BLUE EARTH	-	TO REMAIN
3	12-UNIT T-HANGAR	CITY OF BLUE EARTH	1125' EST.	TO REMAIN
4	COLD STORAGE HANGAR	CITY OF BLUE EARTH	1135' EST.	ULTIMATE RELOCATED
5	8-UNIT T-HANGAR	CITY OF BLUE EARTH	1125' EST.	TO REMAIN
6	FUEL PUMPS	CITY OF BLUE EARTH	-	TO REMAIN
7	SHOP HANGAR	CITY OF BLUE EARTH	1137' EST.	TO REMAIN
8	FBO HANGAR	CITY OF BLUE EARTH	1137' EST.	TO REMAIN
9	A/D BUILDING	CITY OF BLUE EARTH	1127' EST.	TO REMAIN
10	ELECTRICAL BUILDING	CITY OF BLUE EARTH	-	TO REMAIN

NO.	BUILDING TYPE	OWNER	TOP ELEV.	ULTIMATE DISPOSITION
11	SITE STORAGE	CITY OF BLUE EARTH	-	TO BE CONSTRUCTED
12	10-UNIT T-HANGAR	CITY OF BLUE EARTH	-	TO BE CONSTRUCTED
13	COMMERCIAL HANGAR	-	-	TO BE CONSTRUCTED
14	PRIVATE HANGAR	-	-	TO BE CONSTRUCTED
15	PRIVATE HANGAR	-	-	TO BE CONSTRUCTED
16	PRIVATE HANGAR	-	-	TO BE CONSTRUCTED
17	PRIVATE HANGAR	-	-	TO BE CONSTRUCTED
18	PRIVATE HANGAR	-	-	TO BE CONSTRUCTED
19	PRIVATE HANGAR	-	-	TO BE CONSTRUCTED

NO.	BUILDING TYPE	OWNER	TOP ELEV.	ULTIMATE DISPOSITION
11	SITE STORAGE	CITY OF BLUE EARTH	-	TO BE CONSTRUCTED
12	10-UNIT T-HANGAR	CITY OF BLUE EARTH	-	TO BE CONSTRUCTED
13	COMMERCIAL HANGAR	-	-	TO BE CONSTRUCTED
14	PRIVATE HANGAR	-	-	TO BE CONSTRUCTED
15	PRIVATE HANGAR	-	-	TO BE CONSTRUCTED
16	PRIVATE HANGAR	-	-	TO BE CONSTRUCTED
17	PRIVATE HANGAR	-	-	TO BE CONSTRUCTED
18	PRIVATE HANGAR	-	-	TO BE CONSTRUCTED
19	PRIVATE HANGAR	-	-	TO BE CONSTRUCTED