

SRE BUILDING DESIGN FEES 2017  
BLUE EARTH MUNICIPAL AIRPORT

1. Value Engineering	\$6,990
(Includes value engineering time from last spring after the first bid, discussions with several contractors for viable alternatives, meetings with FAA for approval of alternative layouts, meetings with City and Airport staff to review alternatives)	
2. Redesign of SRE Building	\$12,885
(Includes modifying plans per the list of directed changes, modifying the technical and special provisions for the contract documents to reflect the requested changes to the building, and materials and preparation for rebidding. The original cost of the first plan set was \$52,100.00)	
3. Soil Borings	\$5,550
(Work added to remove uncertainty of the bidders on the existing site conditions and remove this cost from the construction bid)	
4. Bidding	\$2,295
(Bidding of the project and to pursue additional contractors for bidding through promoting the project to entice additional bidders)	
Total Design Fee:	<u>\$27,720</u>
Rounded	\$28,000

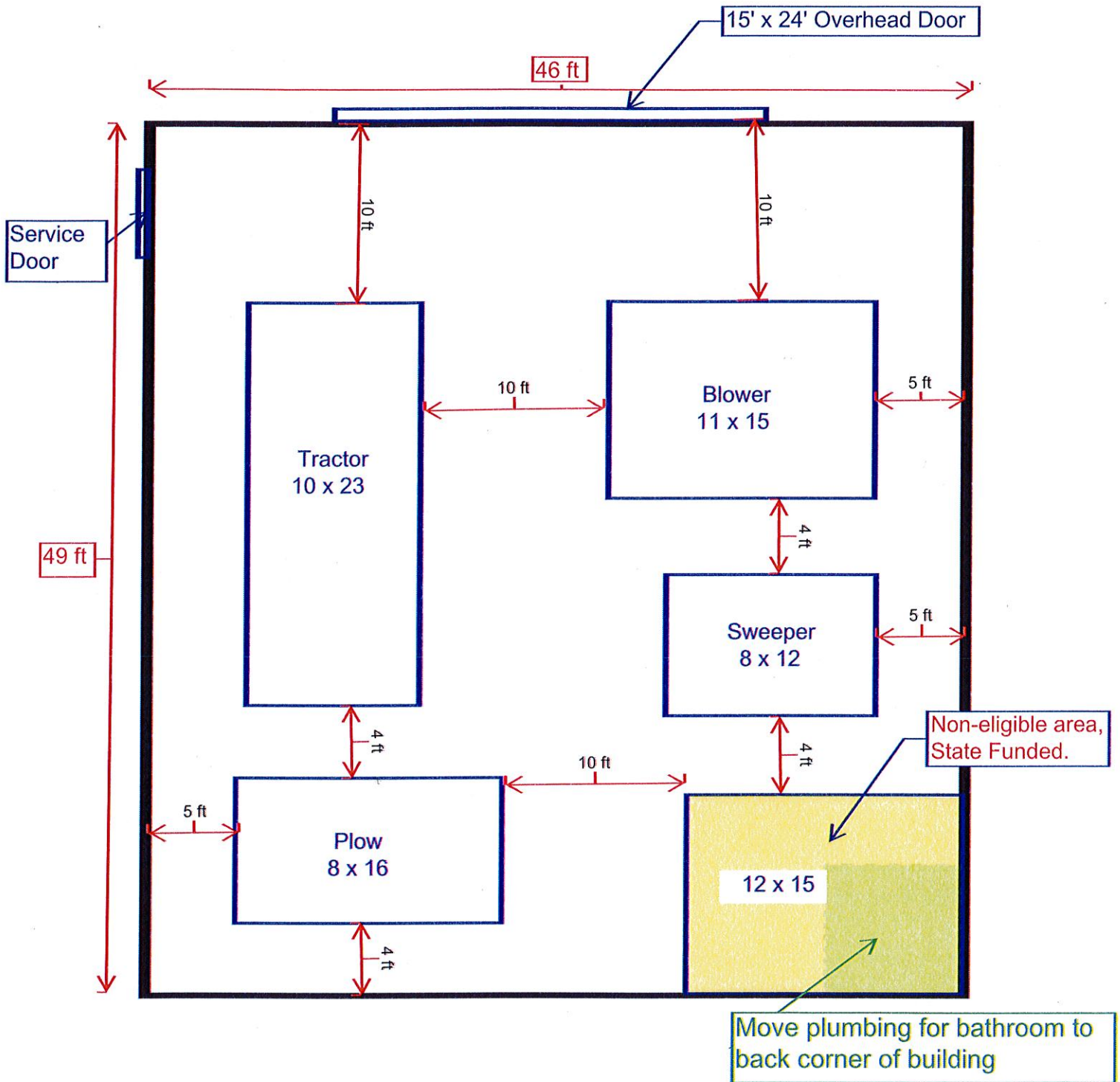

**Blue Earth Municipal Airport  
Revised SRE Building 46'x49'**

Eligible Area = 2074 sf

Non-Eligible Area = 180sf

Total Area = 2254 sf

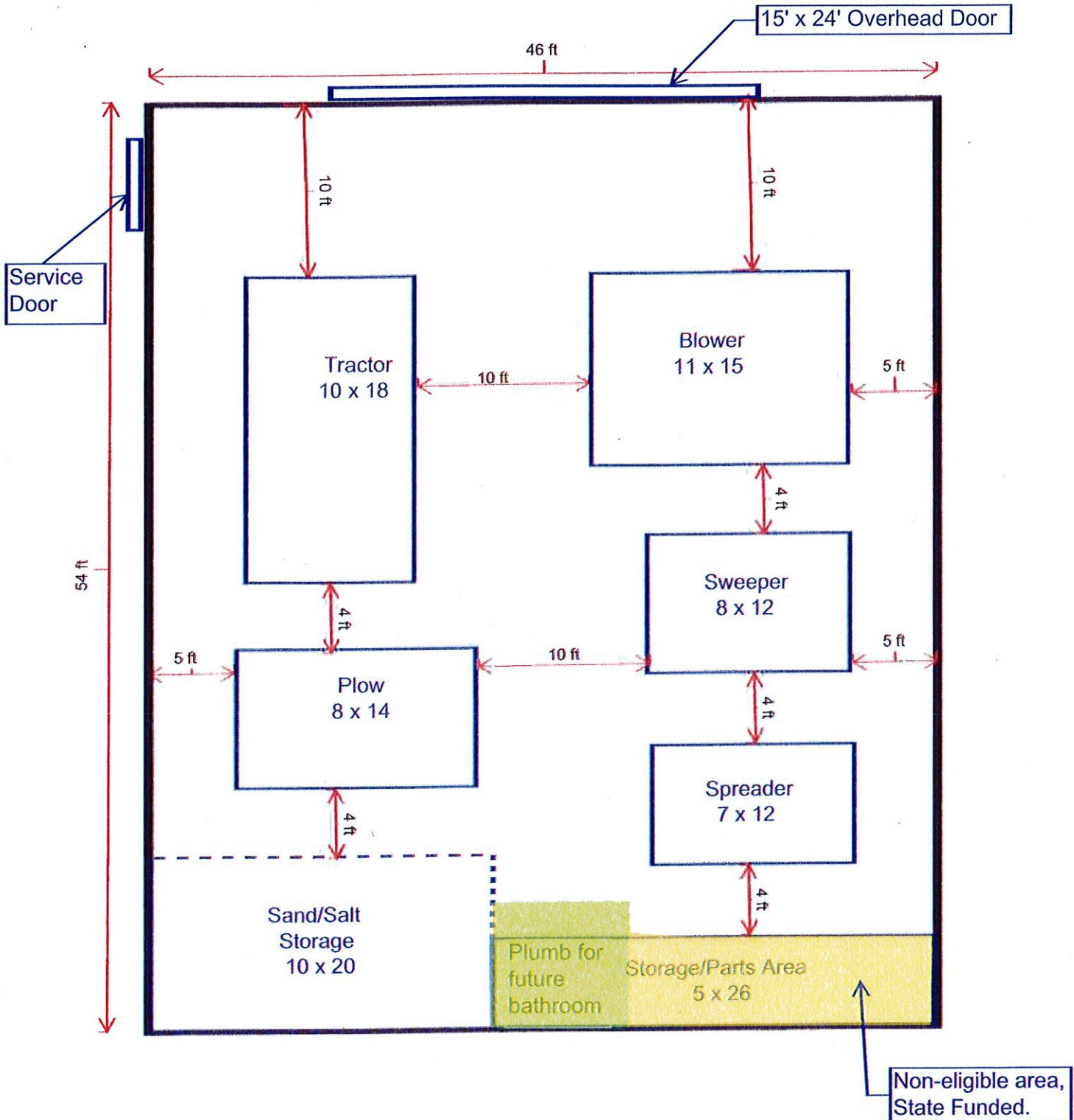

**Blue Earth Municipal Airport  
SRE Building 46'x 54'**

Eligible Area = 2354 sf

Non-Eligible Area = 130sf

Total Area = 2484 sf